

DETOUR ROUTE - CLONARD STREET AND HARRY REYNOLDS RD - SECTION 1

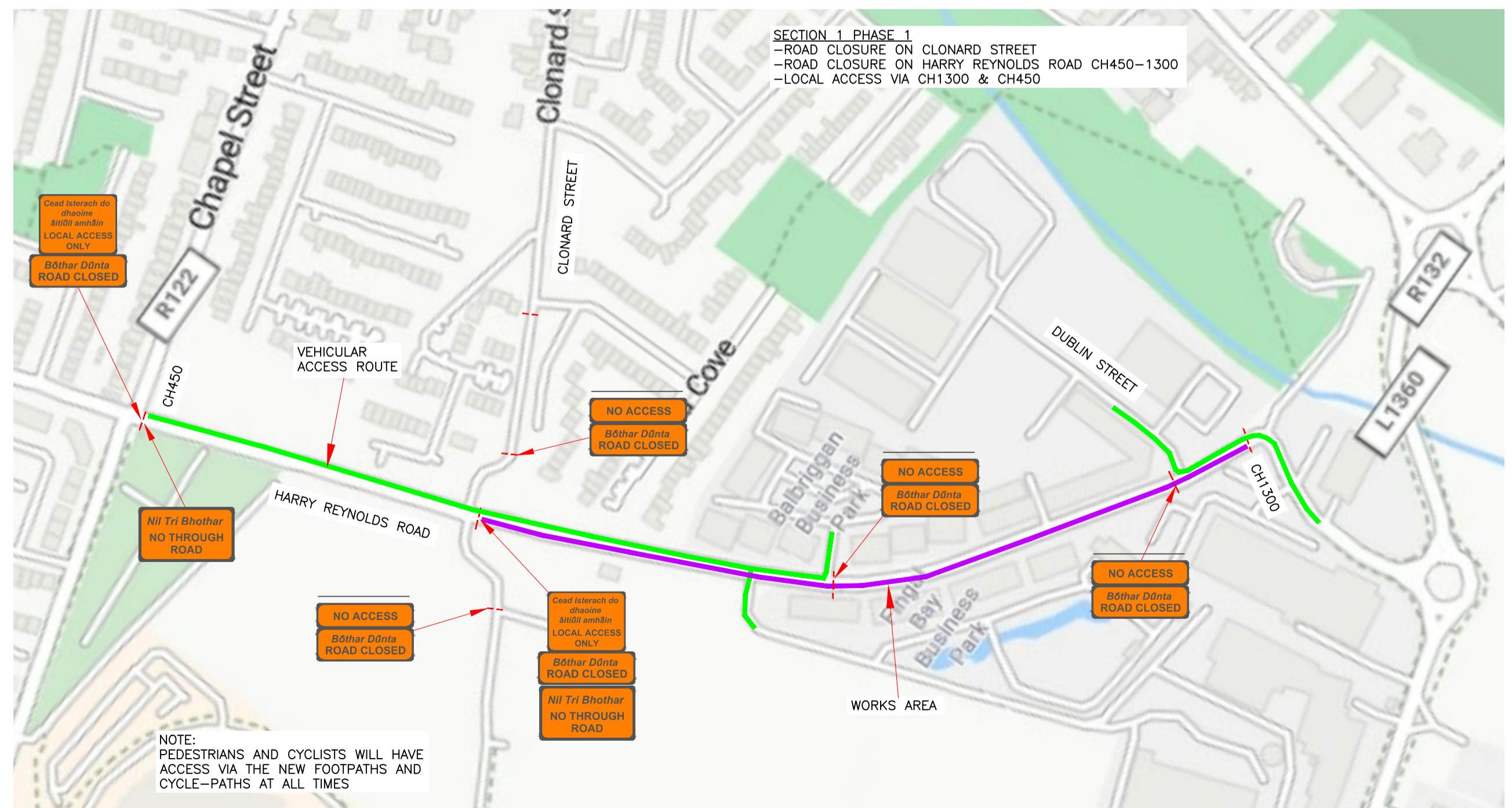

SECTION 1 - PHASE 1

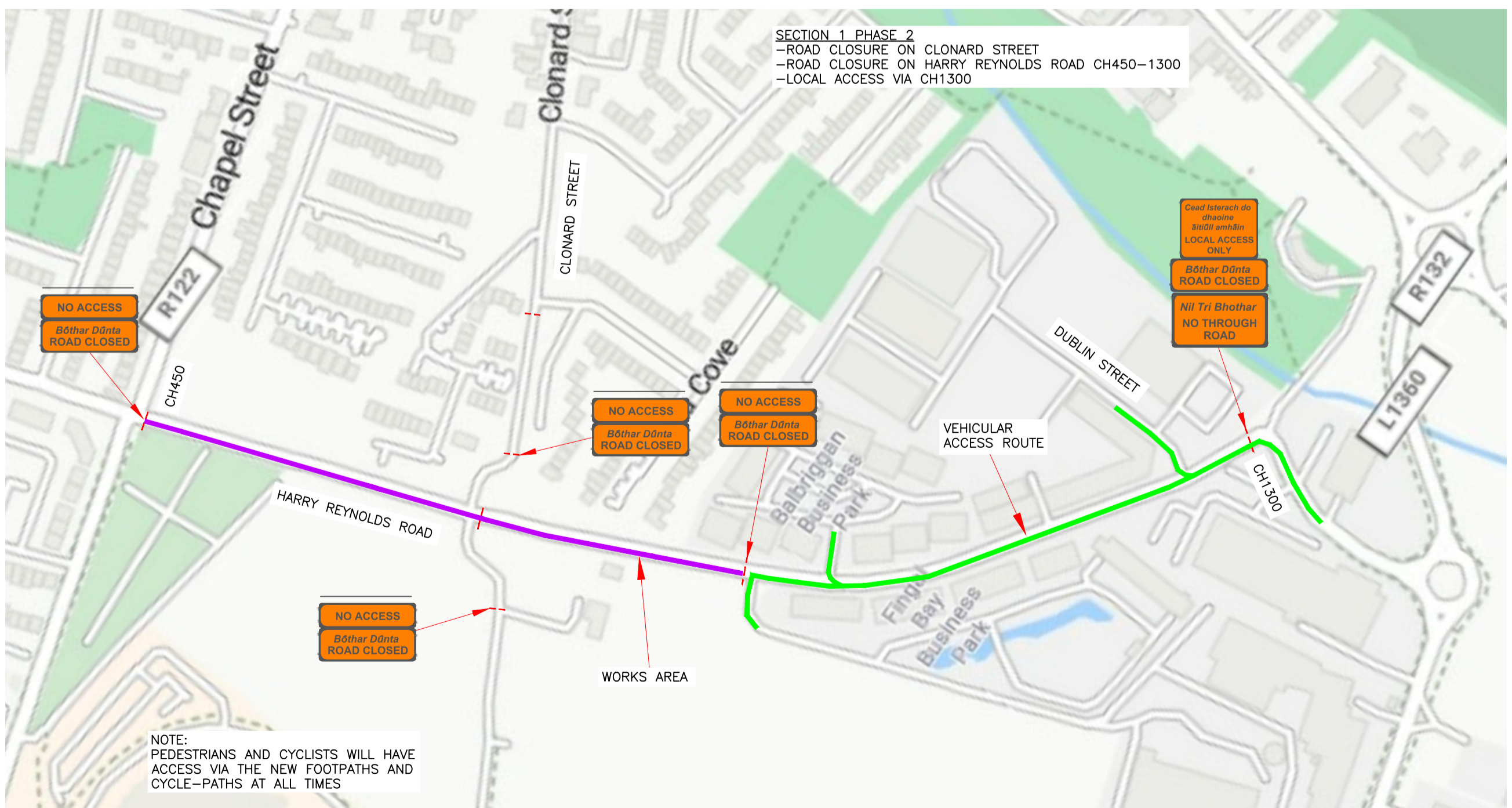

SECTION 1 - PHASE 2

- NOTES:**
- Advance signs to be as per Chapter 8 - TTMS, Table 8.2.2.4 Level 1 (iii) 50km/h
 - End of Roadworks sign placed 20 to 50m from end of works area

LEGEND

- CONES
- DETOUR - HARRY REYNOLDS ROAD
- DETOUR - CLONARD ST
- VEH ACCESS ROUTE
- WORKS AREA

Rev.	Drawn	Checked	EM	Approved	Date	Description
0	AP				27/06/24	FIRST SUBMISSION

Client
Comhairle Contae Fhine Gall
 Fingal County Council

Contractor

Project Title
HARRY REYNOLDS ROAD PEDESTRIAN & CYCLIST ROUTE

Drawing Title
TTMS LAYOUT FOR DETOUR ROUTE HARRY REYNOLDS RD CLONARD ST SECTION 1

Scale AT A1 NTS AT A3 NTS	Date 27-06-2024	Drawn by AP
Drawing no. 1335-TM-033	Rev. 1	