

## D477030 Turvey Bridge MV T&D

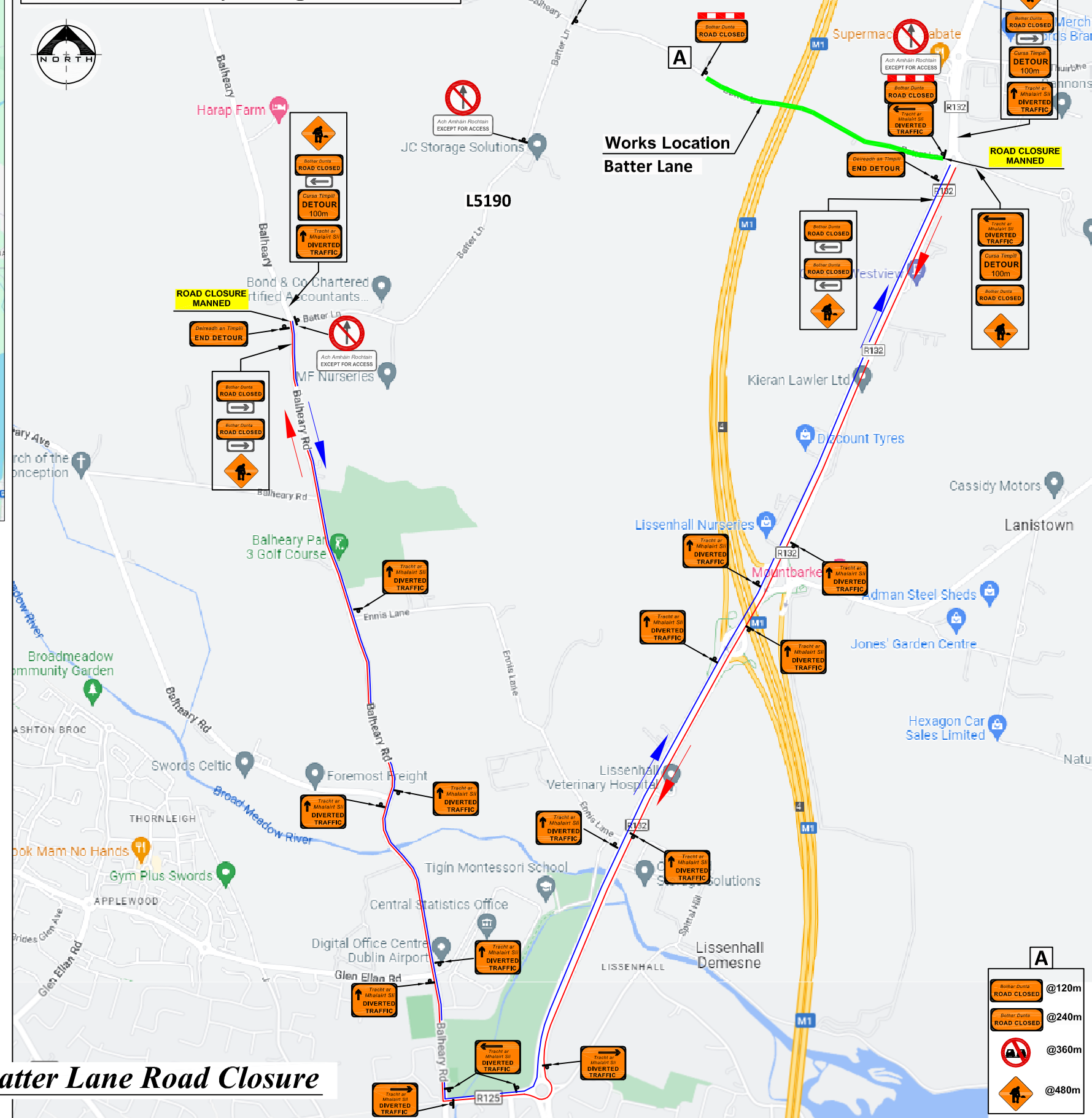

**LEGEND**

- Sign Location
- Works Area
- Proposed Diversion Route

- Design Parameters for Level 1(iv) 2(i)**
1. Statutory Speed of the Road 60km/h 80km/h
  2. Distance between Adv. Signs: 20m 120m
  3. Number of Advance Signs: 3(2) 4(3)
  4. Minimum Visibility of Signs: 60m 90m
  5. Longitudinal Safety Zone: 15m 45m
  6. Lateral Safety Zone: 0.5m 1.2m
  7. Leading Taper: 1:10 1:40
  8. Max.at Tapers Cone Space: 3m 3m
  9. Max. Longitudinal Cone Space: 6m 12m
  10. Cone Height: 750mm
  11. Sign Size: 600mm

- Note:**
1. All signs to comply with Chapter 8 of the "Traffic Signs Manual"-Guidance Document.
  2. All Traffic Management to be carried out in accordance with Chapter 8 of the "Traffic Signs Manual".
  3. SSWP to be completed prior to works commencing
  4. The Contractor shall be responsible for providing all required ramp access to all changes in road surface level where traffic runs on a temporary surface and also for cycle/pedestrian ramps where footpath, cycle paths or any surface which has a level discontinuity as a result of the works. Exact sign positions to be agreed by TTOS implementing traffic management on site
  5. All safety zones to be maintained at all times.
  6. All affected Parties and An Garda Siochana to be notified by Niaron prior to works commencing.
  7. Signs to be positioned so as not to cause an obstruction to other road users.
  8. All signs to be faced with retro-reflective material to class ref 2 of EN 12899.
  9. All delineation devices should be designed in accordance with IS EN 13422.
  10. Safety barrier to be in accordance with IS EN 1317.
  11. "End of Roadworks" sign placed 20m to 50m from end of works area
  12. Local access and emergency services access only will be catered for at all times.
  13. Road closure to be manned.

**A**

- @120m
- @240m
- @360m
- @480m

### Proposed Diversion Route for Batter Lane Road Closure

	Rev:	Description:	Date:	Job Details:	Drawing:	Dwg no:
				Proposed ESB Works D477030 Turvey Bridge MV T&D at Batter Lane Turvey Donabate Co Dublin	Traffic Management Plan for Diversion / Road Closure Batter Lane	052
				Sheet:	Project/Job No:	Rev:
					Drawn By: AK	Scale: As Shown
					Date: Aug 2024	